

Drawing Schedule

DUNDRUM VILLAGE STRATEGIC HOUSING DEVELOPMENT (SHD)

Job Ref: TDUN009

Date: 08,03,22

Drawing title	Drawing number	Date	Revision
TDUN009 101-104 TREE SURVEY & CONSTRAINTS	101-104	05,08,21	-
TDUN009 105-108 ARBORICULTURAL IMPACT REV B	105-108	08,03,22	B
TDUN009 109-112 TREE PROTECTION REV B	109-112	08,03,22	B

Signed:



Ciaran Keating

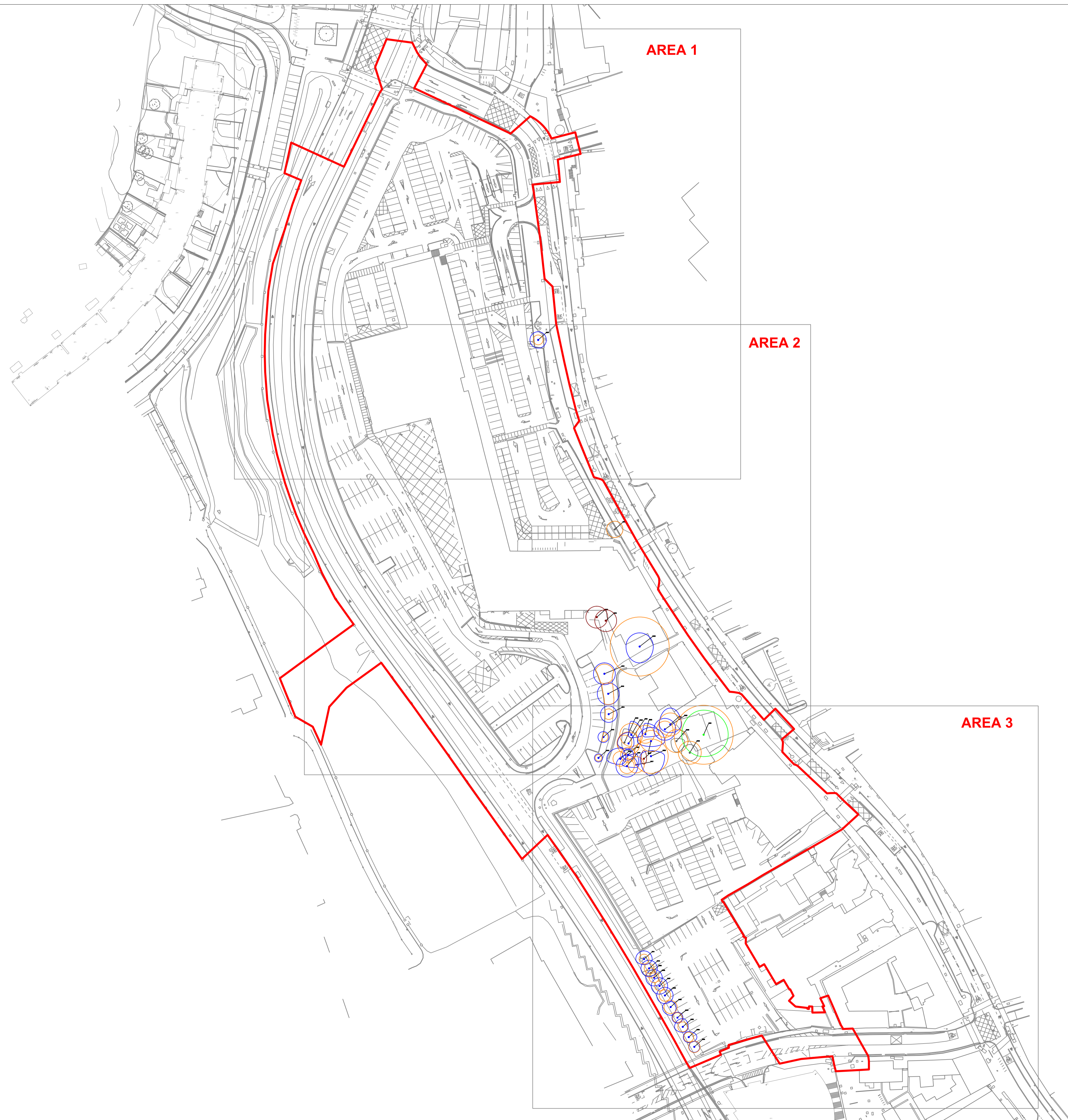

- LEGEND**
- TREE CONDITION CATEGORIES**
- A TREES OF HIGH VALUE AND QUALITY
 - B TREES OF MODERATE VALUE AND QUALITY
 - C TREES OF LOW QUALITY AND VALUE
 - U TREES OF VERY LOW VALUE AND QUALITY TO BE REMOVED IN THE INTERESTS OF SOUND ARBORICULTURAL MANAGEMENT
- TREE CONSTRAINTS
— SITE BOUNDARY

Drawing to be interpreted with reference to Tree Survey document.

Tree constraints shown are calculated from guidelines contained within BS5837 (2012) within dimensions contained within Section 8 of the Tree Survey document. This outline should not be interpreted as the exact extent of root spread however it is considered the optimal area to be retained free of developmental impacts.

Natural and/or man made barriers such as waterlogged soil or buildings may restrict the spread of tree roots. Crown spreads may also prove to be a constraint particularly where crown reduction may not be possible.

The constraints lines shown on this drawing are therefore a guide only. An on-site assessment should be undertaken in the event of any developments being planned within the areas shown for retained trees.

REVISIONS

REV	DATE	DESCRIPTION

CMK
Consultants & Architects Ltd

CLIENT: QUADRUM METAL OP DAC (ACTING) FOR AND ON BEHALF OF QUADRUM METAL LIMITED PARTNERSHIP	PROJECT: QUADRUM VILLAGE STRATEGIC HOUSING DEVELOPMENT (SHD)	JOB NO: TD0009
DIVISION: ARBORICULTURAL ASSESSMENT & CONSTRAINTS OVERLAY	DATE: 05-08-21	SCALE: 1:750 @ A1
DRAWN BY: CARMEL KELLY	DATE: 05-08-21	DRAWING NO: 101
STATUS: PLANNING	INITIALS: CMK	REVISION:

NOTES:
1. This drawing is a component of the Arboricultural Assessment Report.
2. The drawing is copyright of CMK Architects & Planners Ltd.

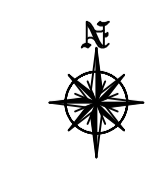

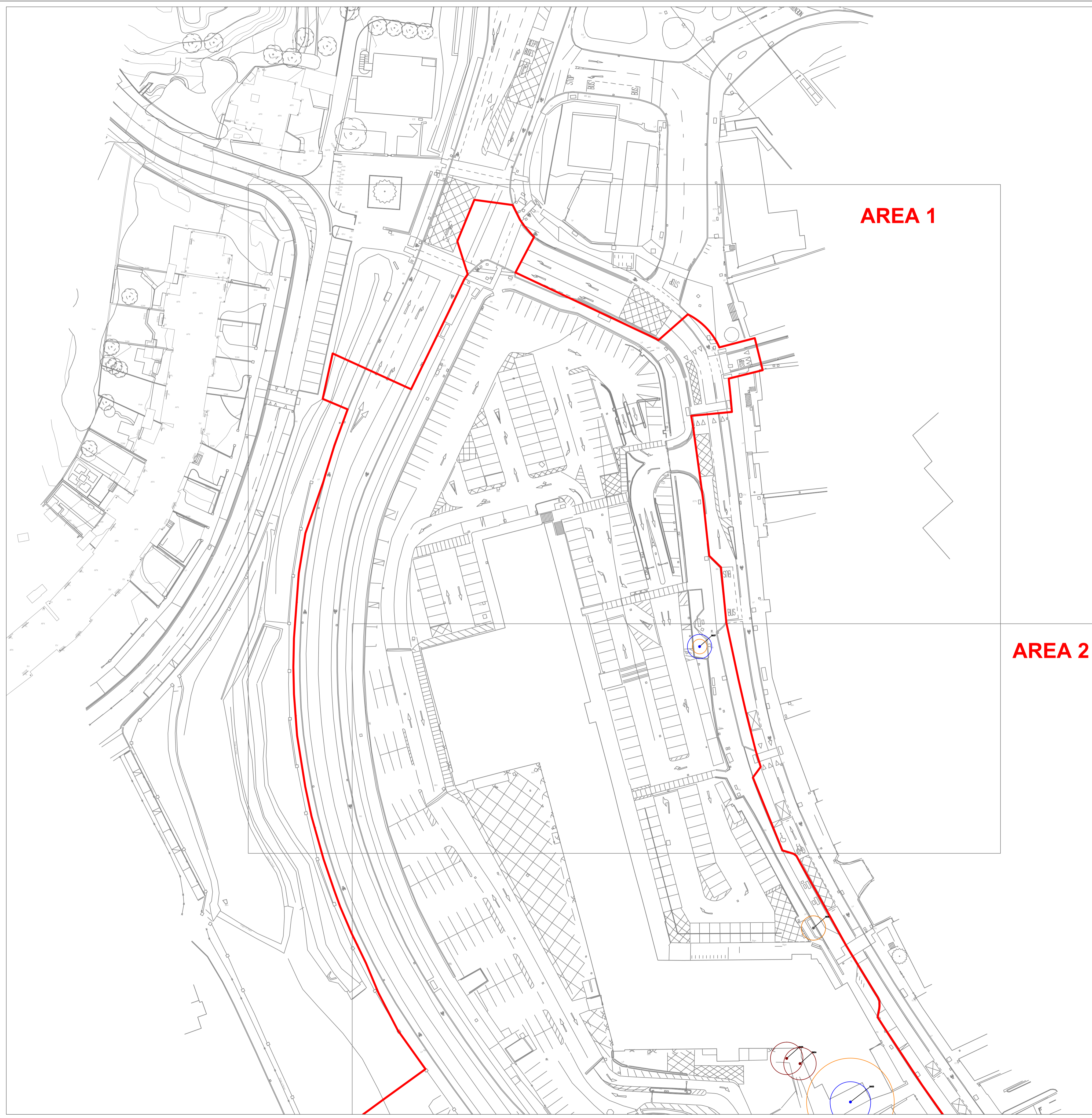

AREA 1

AREA 2

LEGEND

TREE CONDITION CATEGORIES

- A TREES OF HIGH VALUE AND QUALITY
- B TREES OF MODERATE VALUE AND QUALITY
- C TREES OF LOW QUALITY AND VALUE
- U TREES OF VERY LOW VALUE AND QUALITY TO BE REMOVED IN THE INTERESTS OF SOUND ARBORICULTURAL MANAGEMENT

- TREE CONSTRAINTS
- SITE BOUNDARY

Drawing to be interpreted with reference to Tree Survey document.

Tree constraints shown are calculated from guidelines contained within BS5837 (2012) within dimensions contained within Section 8 of the Tree Survey document. This outline should not be interpreted as the exact extent of root spread however it is considered the optimal area to be retained free of developmental impacts.

Natural and/or man made barriers such as waterlogged soil or buildings may restrict the spread of tree roots. Crown spreads may also prove to be a constraint particularly where crown reduction may not be possible.

The constraints lines shown on this drawing are therefore a guide only. An on-site assessment should be undertaken in the event of any developments being planned within the areas shown for retained trees.

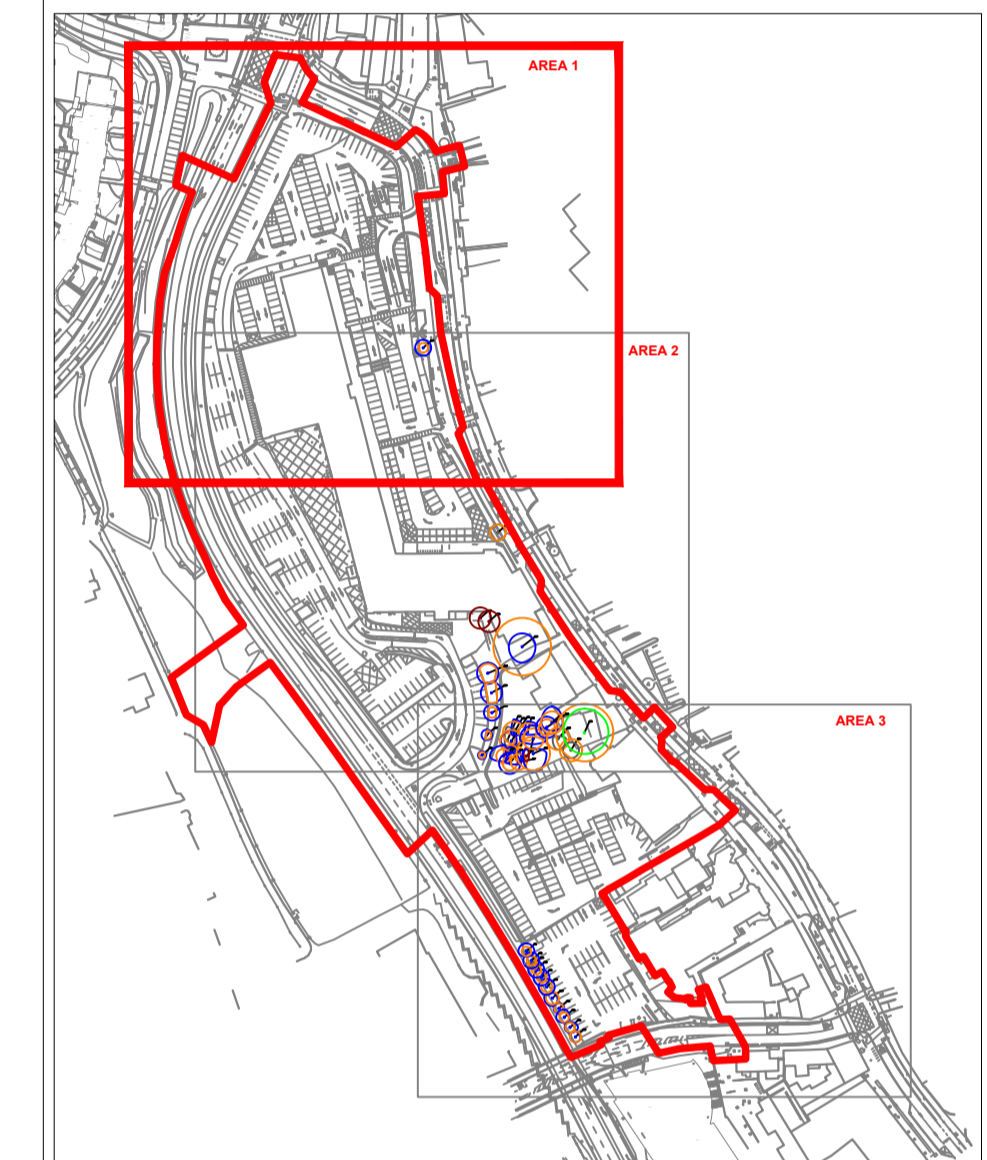

SITE OVERVIEW: NTS

REVISIONS		
REV	DATE	DESCRIPTION

CMK			
CLIENT: Dundrum Retail OP DAC (Acting for and on behalf of Dundrum Retail Limited Partnership)	PROJECT: DUNDUM VILLAGE STRATEGIC HOUSING DEVELOPMENT (SHD)	DATE: 05.09.21	SCALE: 1:50 @ A1
DRAWING: DRIVE - ARBORICULTURAL ASSESSMENT & CONSTRAINTS ZONE	DESIGNED BY: CARMEL KEATING	DATE: 05.09.21	SCALE: 1:50 @ A1
NOTES: This drawing is for information only and should not be used for construction purposes without the approval of the architect.	STATUS: PLANNING	DATE: 05.09.21	SCALE: 1:50 @ A1



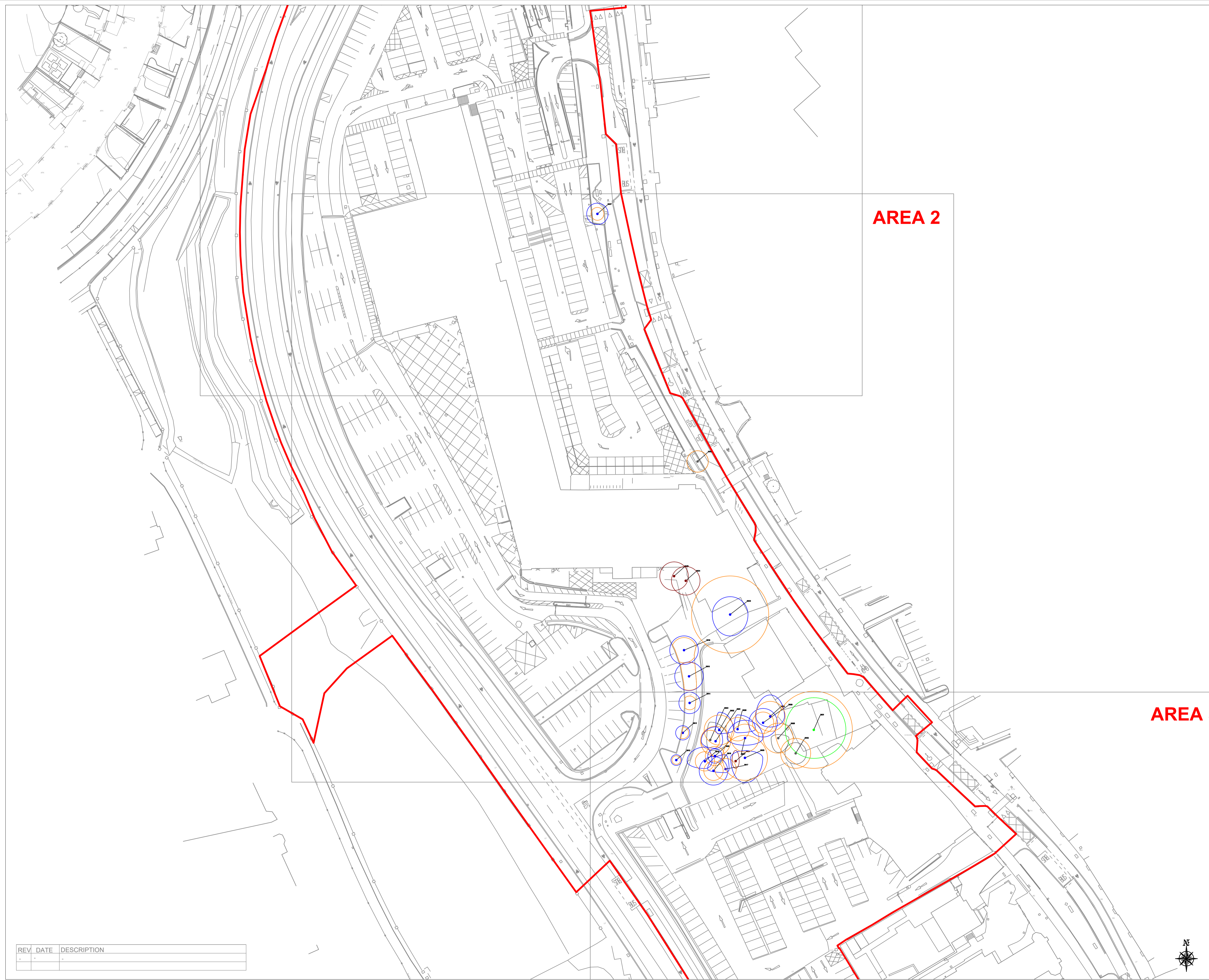

LEGEND

TREE CONDITION CATEGORIES

- A TREES OF HIGH VALUE AND QUALITY
- B TREES OF MODERATE VALUE AND QUALITY
- C TREES OF LOW QUALITY AND VALUE
- U TREES OF VERY LOW VALUE AND QUALITY TO BE REMOVED IN THE INTERESTS OF SOUND ARBORICULTURAL MANAGEMENT

- TREE CONSTRAINTS
- SITE BOUNDARY

Drawing to be interpreted with reference to Tree Survey document.

Tree constraints shown are calculated from guidelines contained within BS5837 (2012) within dimensions contained within Section 6 of the Tree Survey document. This outline should not be interpreted as the exact extent of root spread however it is considered the optimal area to be retained free of developmental impacts. Natural and/or man made barriers such as waterlogged soil or buildings may restrict the spread of tree roots. Crown spreads may also prove to be a constraint particularly where crown reduction may not be possible. The constraints lines shown on this drawing are therefore a guide only. An on-site assessment should be undertaken in the event of any developments being planned within the areas shown for retained trees.

AREA 2

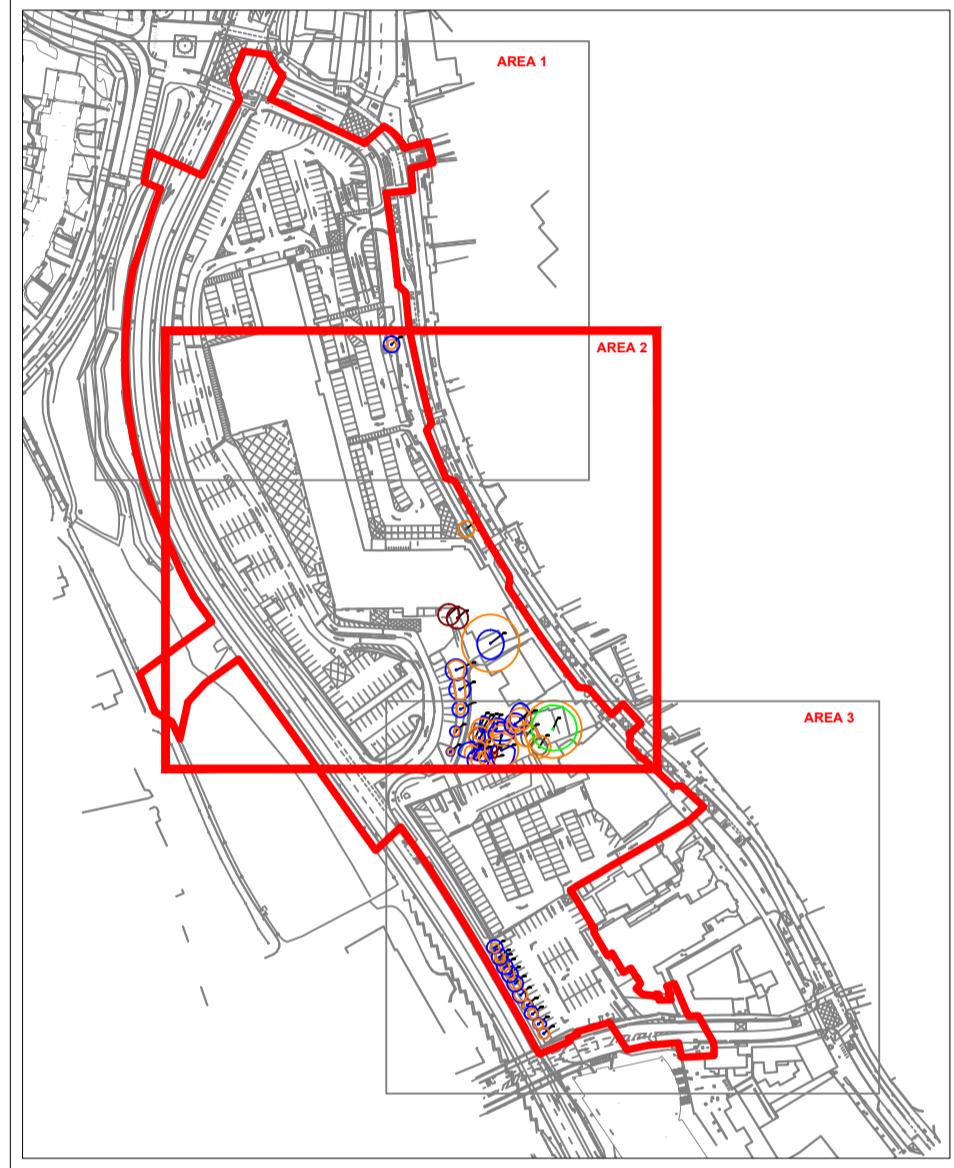

SITE OVERVIEW: NTS

AREA 3

REV	DATE	DESCRIPTION

REVISIONS

REV	DATE	DESCRIPTION

CMK

CLIENT: Dundrum Retail GP DAC (Acting for and on behalf of Dundrum Retail Limited Partnership)	PROJECT: DUNDUM VILLAGE STRATEGIC HOUSING DEVELOPMENT (SHD)	JOB NO. TDUN009
DATE: 05.09.21	SCALE: 1:500 @ A1	DRAWING NO. 103
STATUS: PLANNING	DRAWN BY: CARRIE HARTING	INITIALS: CMK
NOTES: © All rights reserved. No part of this publication may be reproduced, stored in a retrieval system, or transmitted, in any form or by any means, electronic, mechanical, photocopying, recording, or by any information storage and retrieval system, without the prior written permission of CMK.		REVISION:



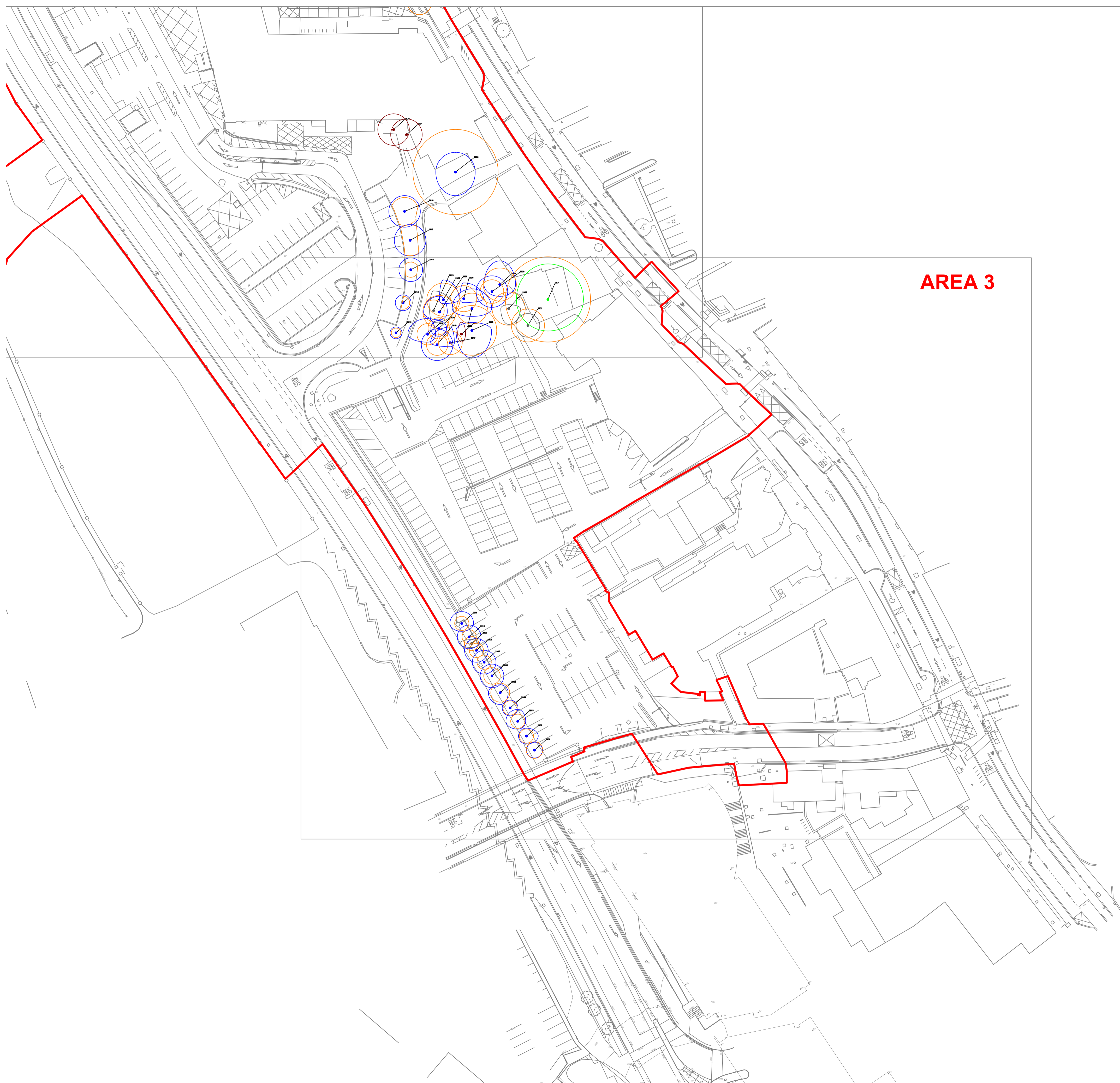

AREA 3

LEGEND

TREE CONDITION CATEGORIES

- A TREES OF HIGH VALUE AND QUALITY
- B TREES OF MODERATE VALUE AND QUALITY
- C TREES OF LOW QUALITY AND VALUE
- U TREES OF VERY LOW VALUE AND QUALITY TO BE REMOVED IN THE INTERESTS OF SOUND ARBORICULTURAL MANAGEMENT

- TREE CONSTRAINTS
- SITE BOUNDARY

Drawing to be interpreted with reference to Tree Survey document.

Tree constraints shown are calculated from guidelines contained within BS5837 (2012) within dimensions contained within Section 8 of the Tree Survey document. This outline should not be interpreted as the exact extent of root spread however it is considered the optimal area to be retained free of developmental impacts. Natural and/or man made barriers such as waterlogged soil or buildings may restrict the spread of tree roots. Crown spreads may also prove to be a constraint particularly where crown reduction may not be possible.

The constraints lines shown on this drawing are therefore a guide only. An on-site assessment should be undertaken in the event of any developments being planned within the areas shown for retained trees.

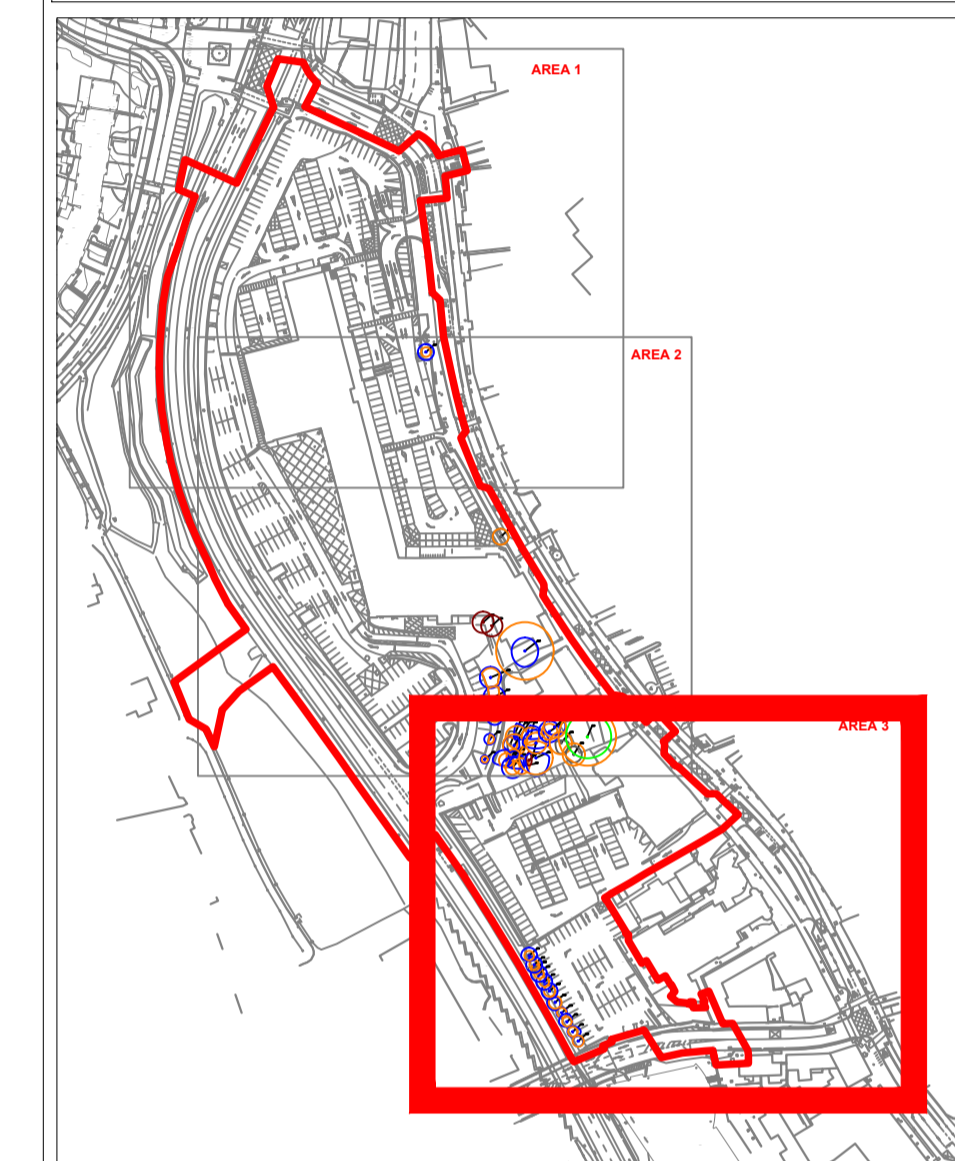

SITE OVERVIEW: NTS

REVISIONS		
REV	DATE	DESCRIPTION

CMK Consultants & Architects Ltd		PROJECT: DUNDEM VILLAGE STRATEGIC HOUSING DEVELOPMENT (SHD)		J26 NO: TDUN009
CLIENT: Dundee Retail GP (CMK Acting for and on behalf of Dundee Retail Limited Partnership)	DRAWING: D20-01: ARBORICULTURAL ASSESSMENT & CONSTRAINTS ZONE	DATE: 06-06-21	SCALE: 1:500 @ A1	DRAWING NO: 104
NOTES: This drawing is the property of CMK and shall not be used for any other project without the written consent of CMK.	DRAWN BY: CHARAN HEATING	CHECKED BY: CMK	REVISION: CMK	STATUS: PLANNING



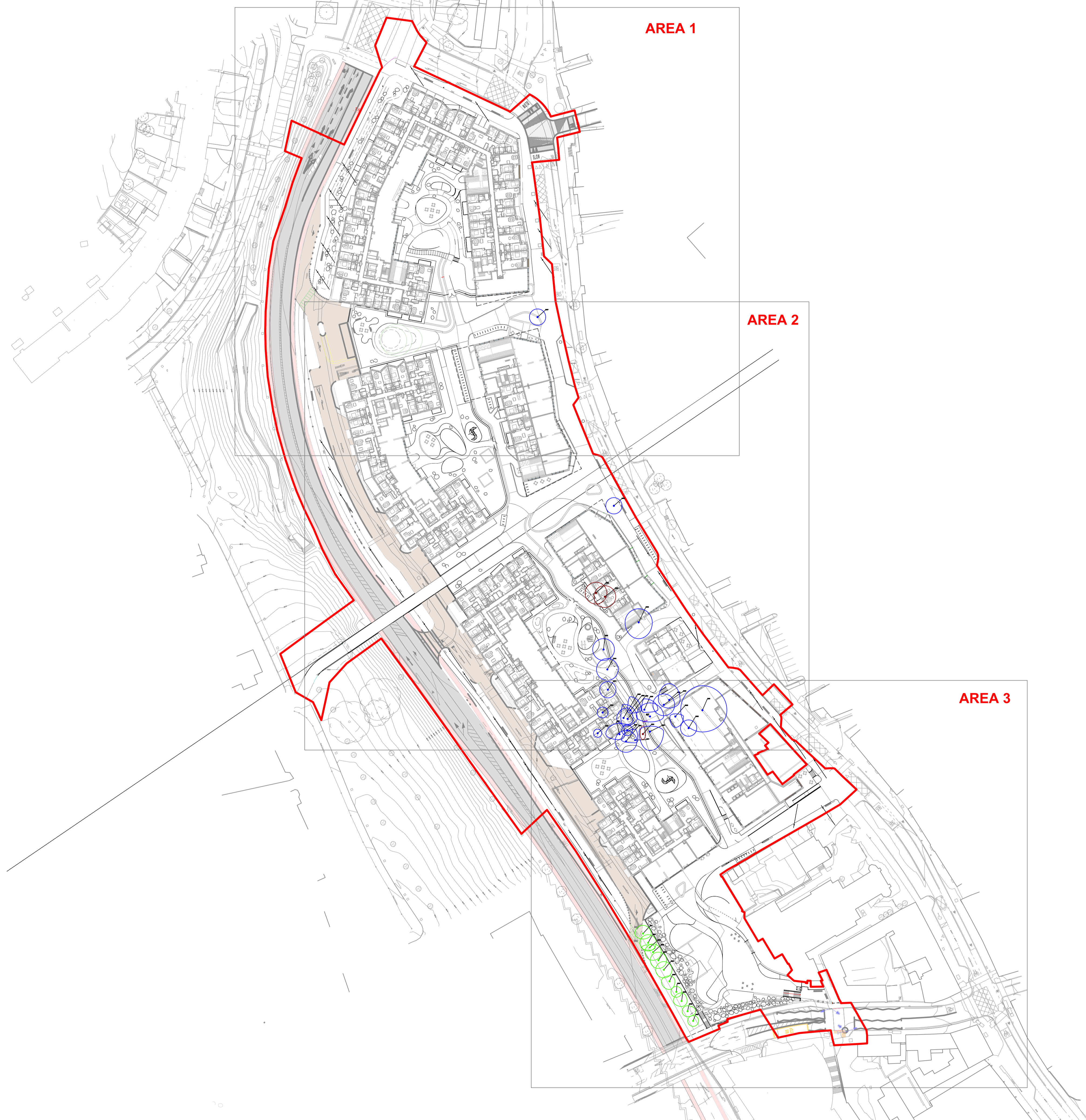

LEGEND

- ARBORCULTURAL IMPACT**
- TREES TO BE RETAINED
 - TREES TO BE REMOVED TO FACILITATE DEVELOPMENT
 - TREES OF VERY LOW VALUE AND QUALITY TO BE REMOVED IN THE INTERESTS OF SOUND ARBORCULTURAL MANAGEMENT
 - SITE BOUNDARY

DRAWING TO REFERENCED WITH REFERENCE TO ARBORCULTURAL ASSESSMENT & IMPACT REPORT

REVISIONS		
REV	DATE	DESCRIPTION
A	23.02.22	REVISED LAYOUT
B	08.03.22	REVISED LAYOUT

CMK Consultants & Architects Ltd		PROJECT: DUNDEEM VILLAGE STRATEGIC HOUSING DEVELOPMENT (SHD)		JOB NO: TDUN009
CLIENT: Dundee Regeneration DAC, acting for and on behalf of Dundee Regeneration Limited Partnership		DRAWING: ARBORCULTURAL IMPACT KEYPLAN	DATE: 08-03-22	SCALE: 1:750 @ A1
NOTES: This drawing is for information only. It has been prepared in accordance with the relevant standards.		DRAWN BY: CARMAN HEATING	DATE: 08-03-22	REVISION: 1
STATUS: PLANNING		INITIALS: CMK		





LEGEND

ARBORCULTURAL IMPACT

- TREES TO BE RETAINED
- TREES TO BE REMOVED TO FACILITATE DEVELOPMENT
- TREES OF VERY LOW VALUE AND QUALITY TO BE REMOVED IN THE INTERESTS OF SOUND ARBORCULTURAL MANAGEMENT
- SITE BOUNDARY

DRAWING TO REFERENCED WITH REFERENCE TO ARBORCULTURAL ASSESSMENT & IMPACT REPORT

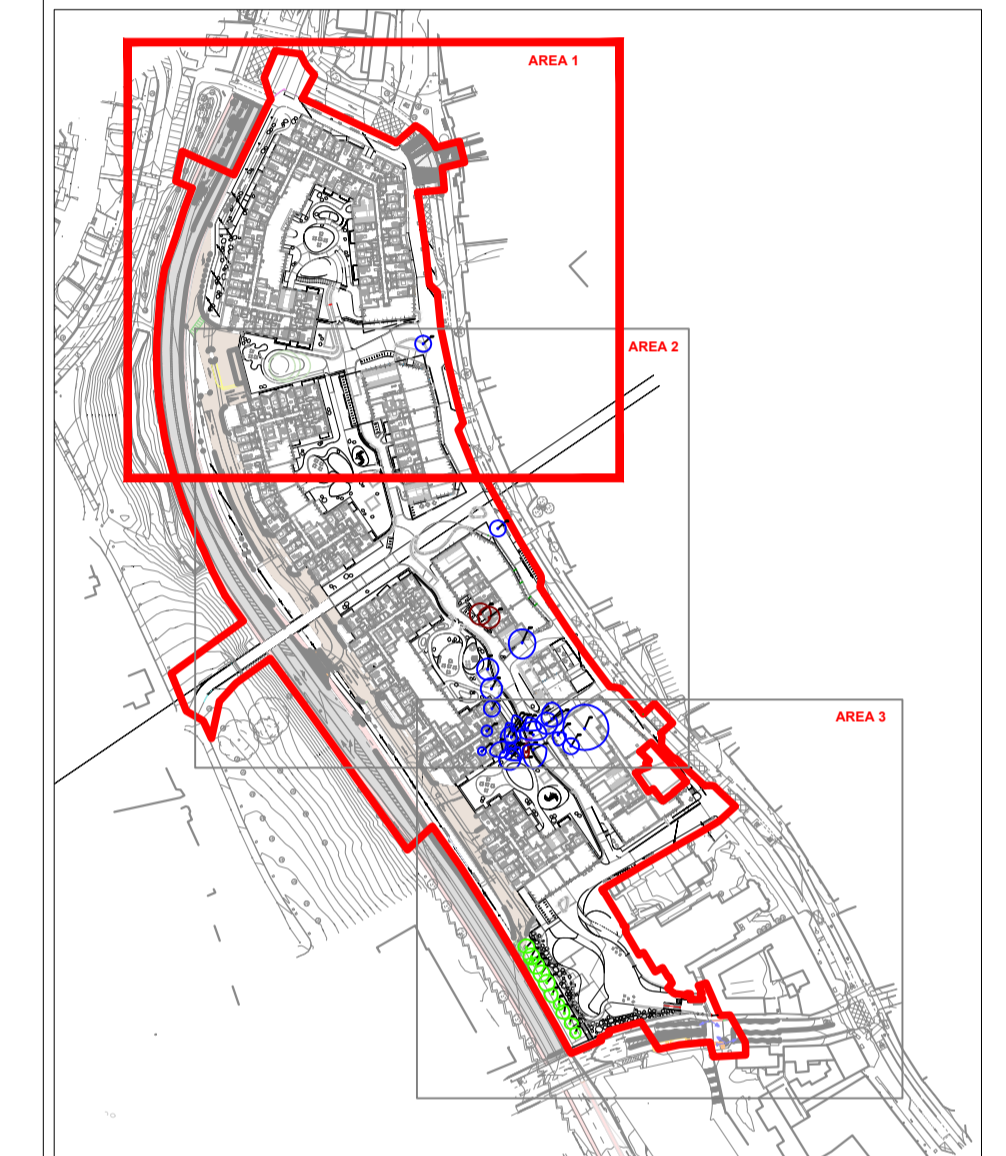

SITE OVERVIEW: NTS

REVISIONS

REV	DATE	DESCRIPTION
A	23.02.22	REVISED LAYOUT
B	08.03.22	REVISED LAYOUT

CMK

CLIENT: Dundrum Retail GP DAC (Acting for and on behalf of Dundrum Retail Limited Partnership)	PROJECT: DUNDUM VILLAGE STRATEGIC HOUSING DEVELOPMENT (SHD)	JOB NO. TDUND009
DATE: 08-03-22	DRAWING: DUIV01-ARBORCULTURAL IMPACT 10P12	DATE: 08-03-22
SCALE: 1:50 @ A1	DRAWN BY: CAROL HEATING	SCALE: 1:50 @ A1
STATUS: PLANNING	DETAILS: CMK	REVISION: B



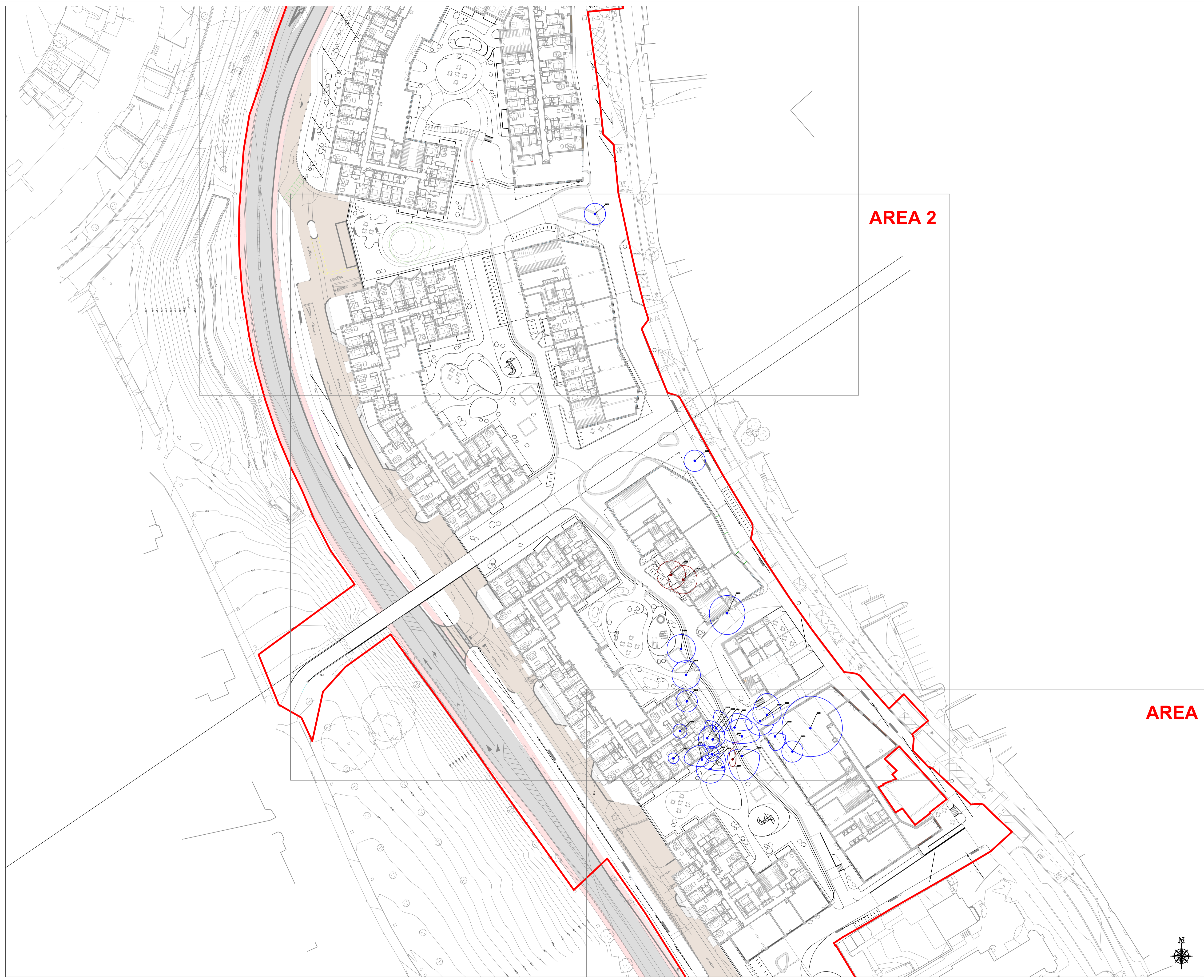

LEGEND

ARBORICULTURAL IMPACT

- TREES TO BE RETAINED
- TREES TO BE REMOVED TO FACILITATE DEVELOPMENT
- TREES OF VERY LOW VALUE AND QUALITY TO BE REMOVED IN THE INTERESTS OF SOUND ARBORICULTURAL MANAGEMENT
- SITE BOUNDARY

DRAWING TO REFERENCED WITH REFERENCE TO ARBORICULTURAL ASSESSMENT & IMPACT REPORT

AREA 2

AREA 3

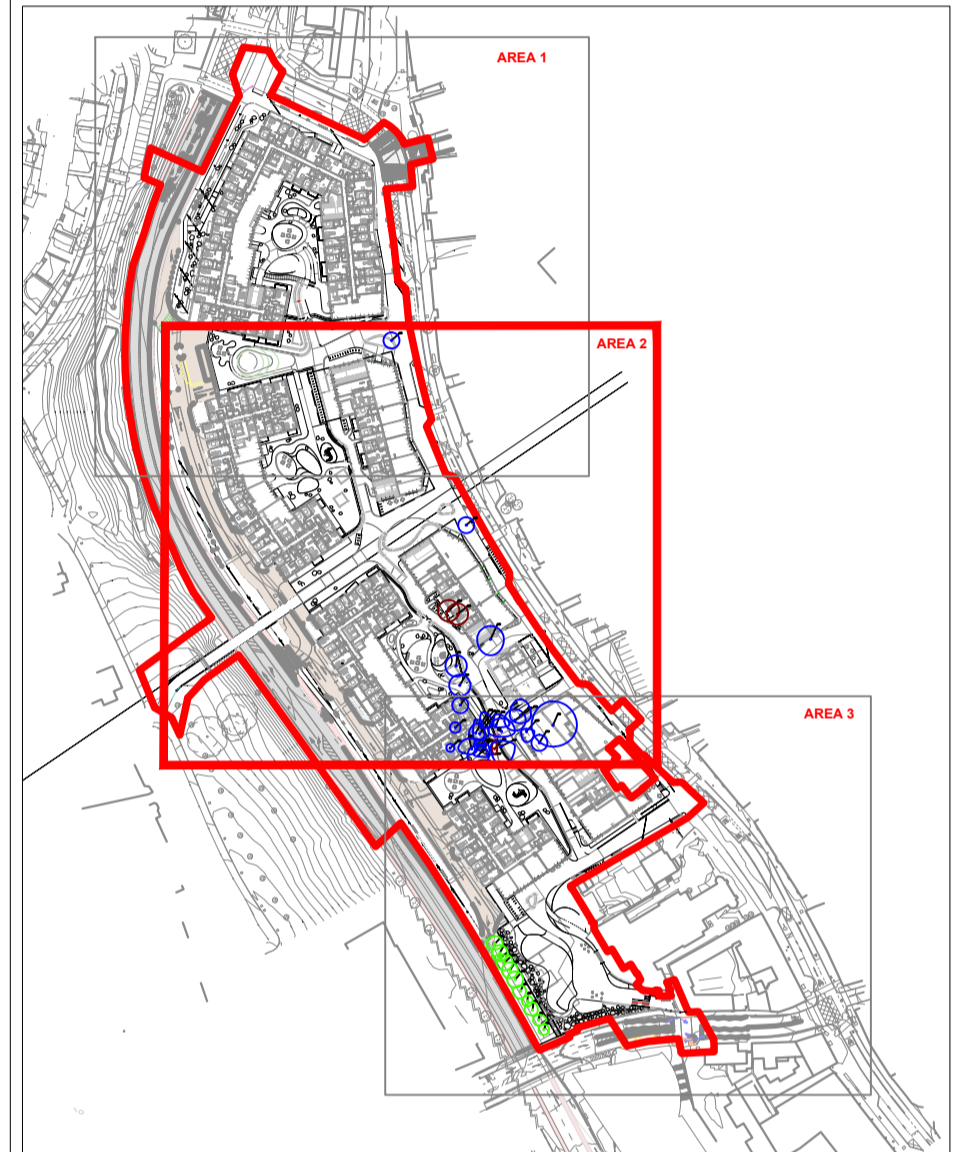

SITE OVERVIEW: NTS

REVISIONS

REV	DATE	DESCRIPTION
A	23.02.22	REVISED LAYOUT
B	08.03.22	REVISED LAYOUT

CMK

CLIENT: Dundrum Retail CPT DAC (Acting for and on behalf of Dundrum Retail Limited Partnership)	PROJECT: DUNDUM VILLAGE STRATEGIC HOUSING DEVELOPMENT (SHD)	JOB NO. TDUN009
DRAWING: DVSHD-ARBORICULTURAL IMPACT 2022	DATE: 08-03-22	SCALE: 1:500 @ A1
STATUS: PLANNING	DRAWN BY: CORRAN KEATING	INITIALS: CMK
		REVISION: #





AREA 3

LEGEND

ARBORICULTURAL IMPACT

- TREES TO BE RETAINED
- TREES TO BE REMOVED TO FACILITATE DEVELOPMENT
- TREES OF VERY LOW VALUE AND QUALITY TO BE REMOVED IN THE INTERESTS OF SOUND ARBORICULTURAL MANAGEMENT
- SITE BOUNDARY

DRAWING TO REFERENCED WITH REFERENCE TO ARBORICULTURAL ASSESSMENT & IMPACT REPORT



SITE OVERVIEW: NTS

REVISIONS		
REV	DATE	DESCRIPTION
A	23.02.22	REVISED LAYOUT
B	08.03.22	REVISED LAYOUT

CMK Consultants & Architects Ltd		PROJECT: DUNDEE VILLAGE STRATEGIC HOUSING DEVELOPMENT (SHD)		J26 NO.: TDUN009
<small>Client: Dundee Regeneration DAC (acting for and on behalf of Dundee Regeneration Limited Partnership)</small>		DRAWING: DISH-ARBORICULTURAL IMPACT 30FY	DATE: 08-03-22	SCALE: 1:500 @ A1
<small>Notes: This drawing is for information only. It is not to be used for construction purposes without the written consent of CMK.</small>		DRAWN BY: GEMMA HEATING	CHECKED BY: CMK	REVISION: 1
<small>It has been checked to confirm that the drawing is in accordance with the relevant standards.</small>		STATUS: PLANNING		





LEGEND

TREE PROTECTION

- TREES TO BE RETAINED
- TREE PROTECTION
- SITE BOUNDARY

DRAWING TO REFERENCED WITH REFERENCE TO ARBORICULTURAL ASSESSMENT & IMPACT REPORT

REVISIONS		
REV	DATE	DESCRIPTION
A	23.02.22	REVISED LAYOUT
B	08.03.22	REVISED LAYOUT

CMK Consultants & Architects Ltd		PROJECT: DUNDEE VILLAGE STRATEGIC HOUSING DEVELOPMENT (SHD)		JOB NO: TDUN009
CLIENT: Dundee Retail GP DAC (acting for and on behalf of Dundee Retail Limited Partnership)		DATE: 08-03-22	SCALE: 1:750 @ A1	DRAWING NO: 109
DRAWING: DSHD - TREE PROTECTION KEYPLAN		DRAWN BY: CHARM HEATING	INITIALS: CHC	REVISION: 1
NOTES: 1. This drawing is a key plan of the site and should be read in conjunction with the Arboricultural Assessment & Impact Report.		STATUS: PLANNING		





LEGEND

TREE PROTECTION

- TREES TO BE RETAINED
- TREE PROTECTION
- SITE BOUNDARY

DRAWING TO REFERENCED WITH REFERENCE TO ARBORICULTURAL ASSESSMENT & IMPACT REPORT

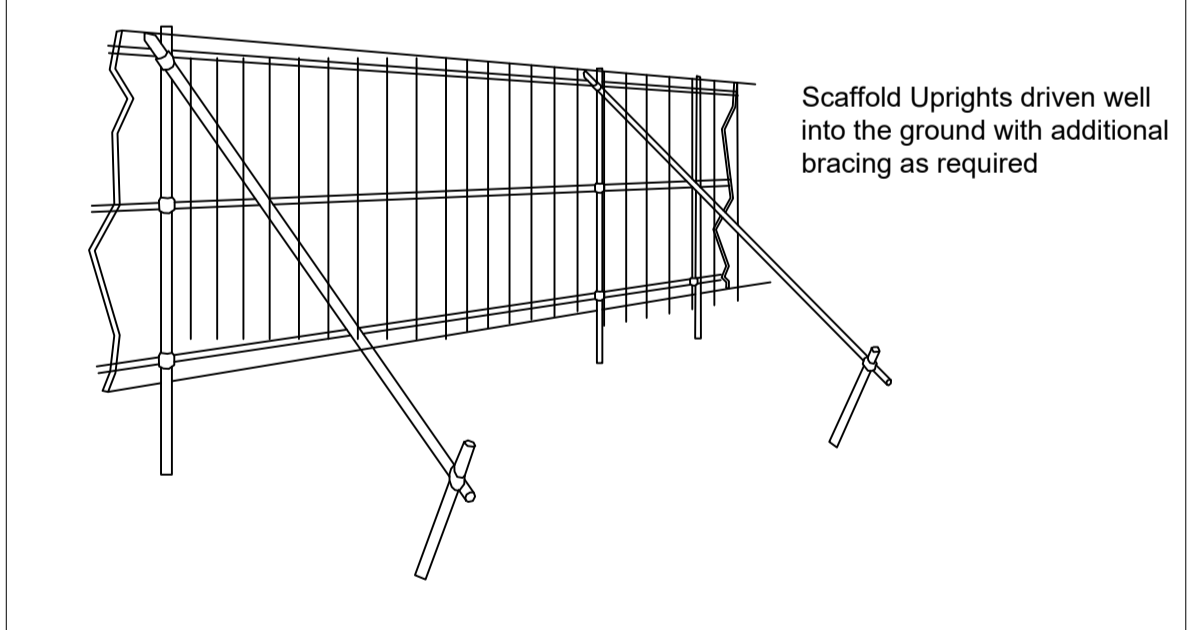

**TREE PROTECTION DETAIL:
HERRAS FENCING OR SIMILAR APPROVED**



REVISIONS			
REV	DATE	DESCRIPTION	
A	23.02.22	REVISED LAYOUT	
B	08.03.22	REVISED LAYOUT	

CMK			
CLIENT: Dundrum Retail GP DAC (Acting for and on behalf of Dundrum Retail Limited Partnership)	PROJECT: DUNDUM VILLAGE STRATEGIC HOUSING DEVELOPMENT (SHD)	DATE: 28.03.22	SCALE: 1:500 @ A1
DRAWING: D/SHD-TREE PROTECTION 10/FY	DRAWN BY: GARRAN HEATING	DATE: 28.03.22	SCALE: 1:500 @ A1
NOTES: SEE THE TREE PROTECTION AREA FOR MORE DETAILS	STATUS: PLANNING	REVISION: CMK	



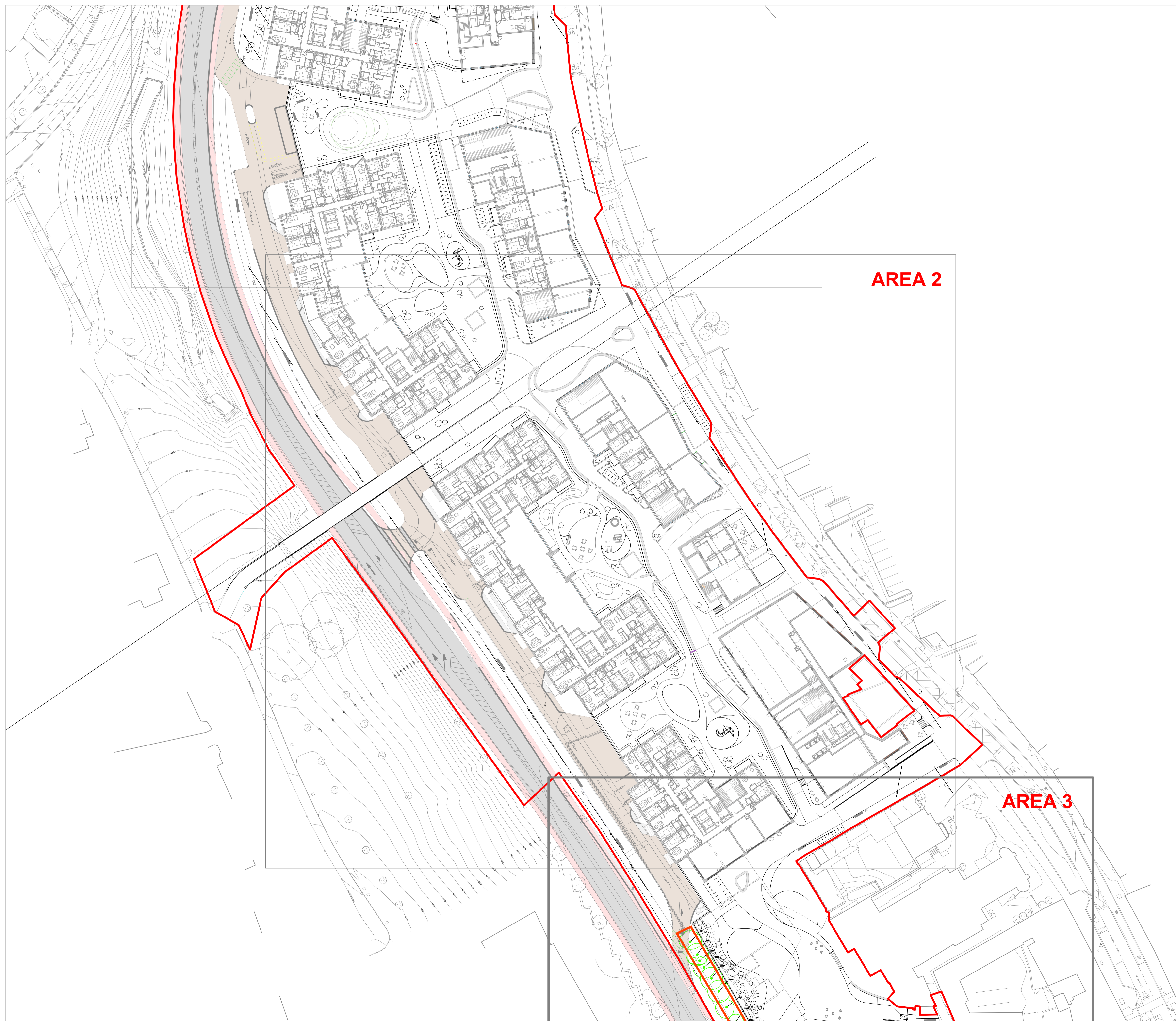

LEGEND

TREE PROTECTION

- TREES TO BE RETAINED
- TREE PROTECTION
- SITE BOUNDARY

DRAWING TO REFERENCED WITH REFERENCE TO ARBORICULTURAL ASSESSMENT & IMPACT REPORT

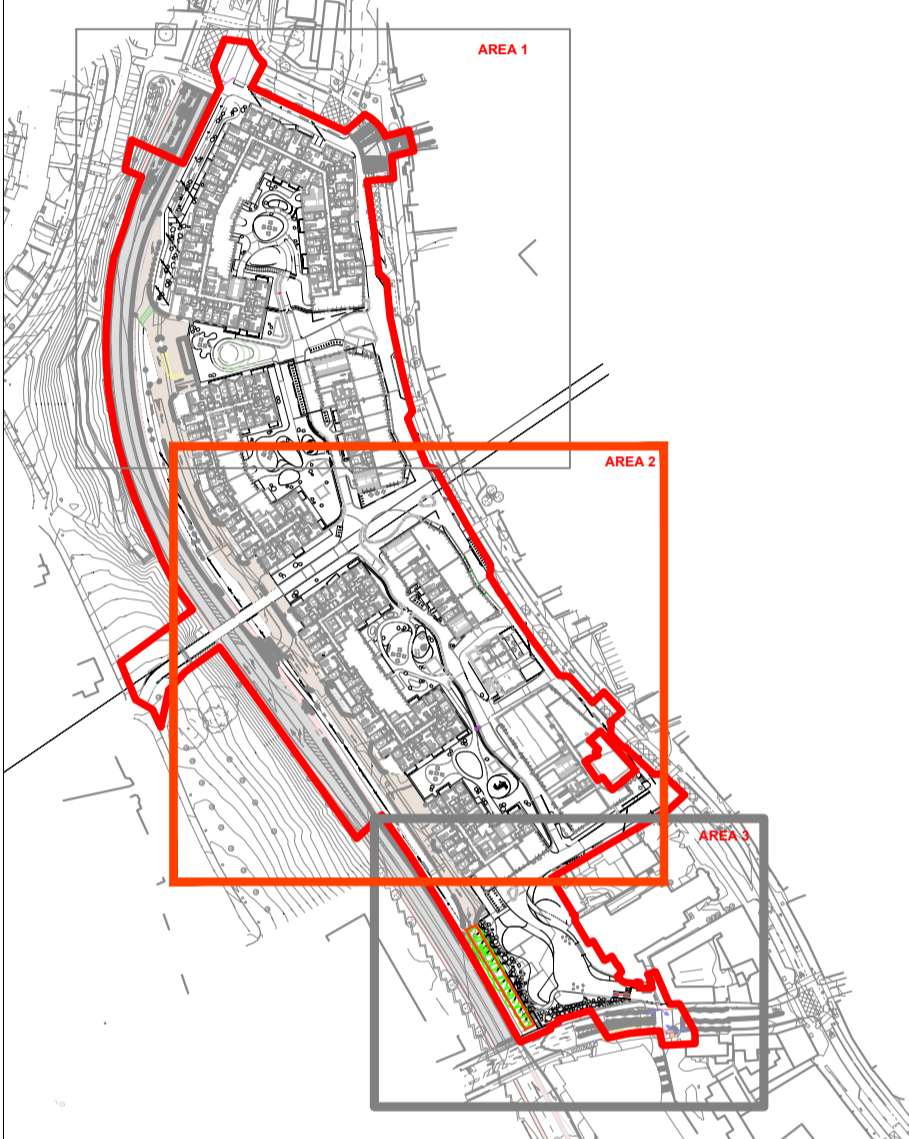

SITE OVERVIEW: NTS

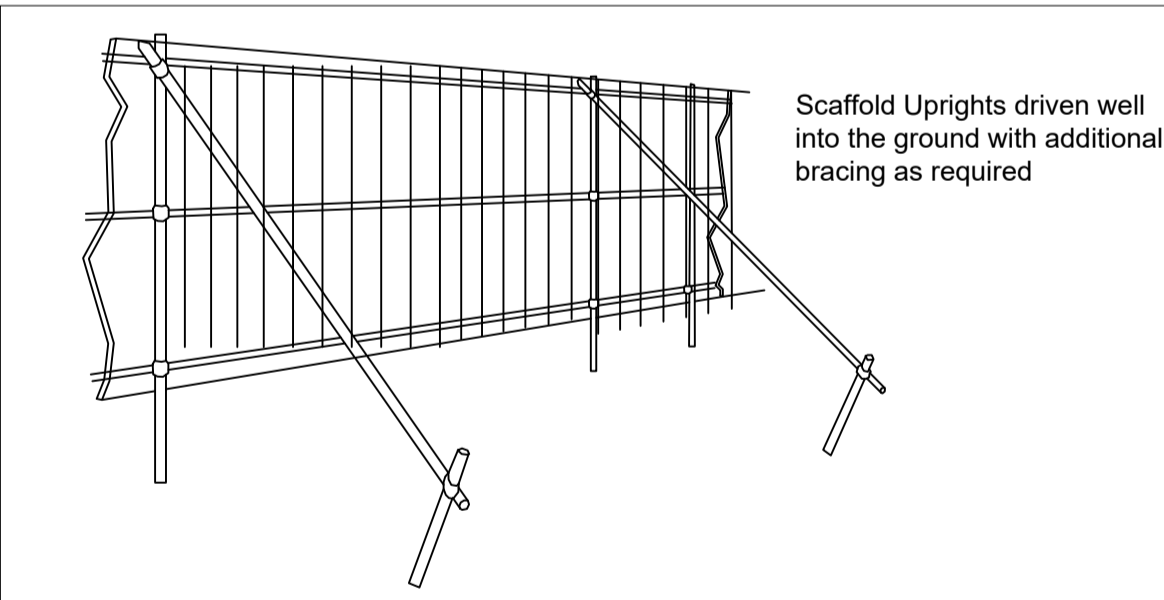

**TREE PROTECTION DETAIL:
HERRAS FENCING OR SIMILAR APPROVED**



REVISIONS		
REV	DATE	DESCRIPTION
A	23.02.22	REVISED LAYOUT
B	08.03.22	REVISED LAYOUT

CMK		PROJECT:	DUNDUM VILLAGE STRATEGIC HOUSING DEVELOPMENT (SHD)	JOB NO:	TDUN009
CLIENT:	Dundum Retail GP DAC (Acting for and on behalf of Dundum Retail Limited Partnership)	DATE:	08-03-22	SCALE:	1:500 @ A1
DRAWING:	DUPH0 - TREE PROTECTION JOBS	DRAWN BY:	CORIAN HOUSTING	INITIALS:	CMK
NOTES:		STATUS:	PLANNING	REVISION:	



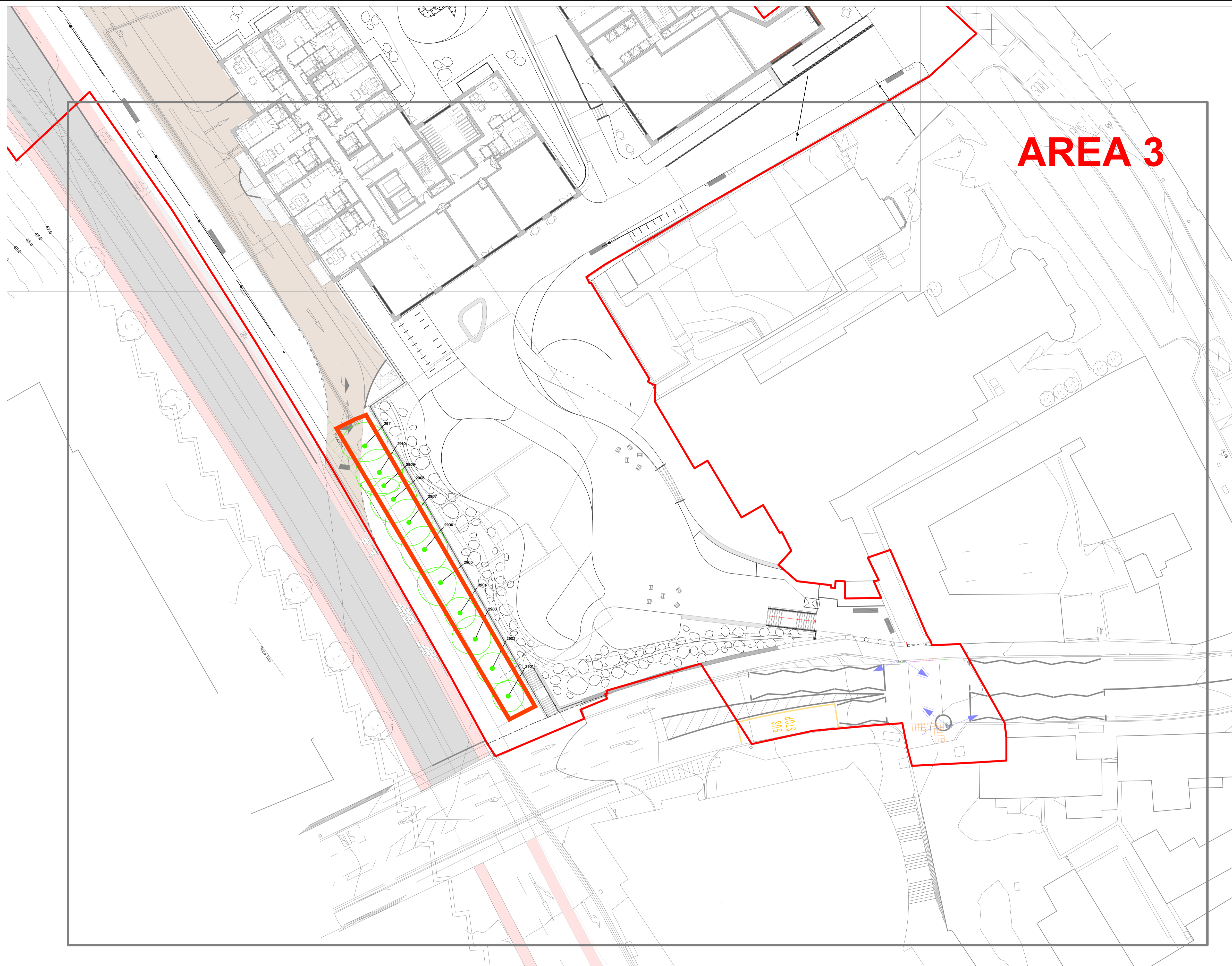

AREA 3

LEGEND

TREE PROTECTION

- TREES TO BE RETAINED
- TREE PROTECTION
- SITE BOUNDARY

DRAWING TO REFERENCED WITH REFERENCE TO ARBORICULTURAL ASSESSMENT & IMPACT REPORT

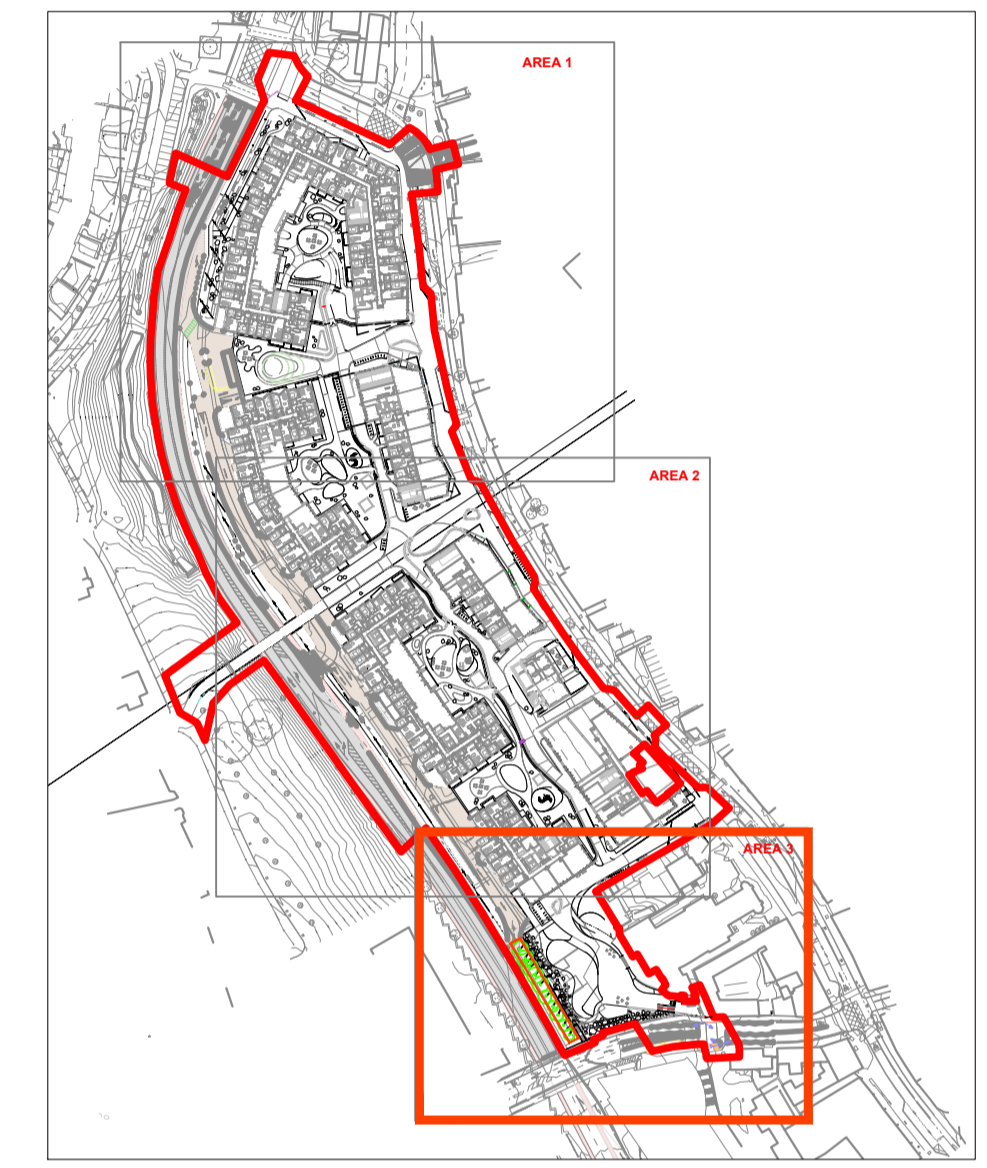

SITE OVERVIEW: NTS

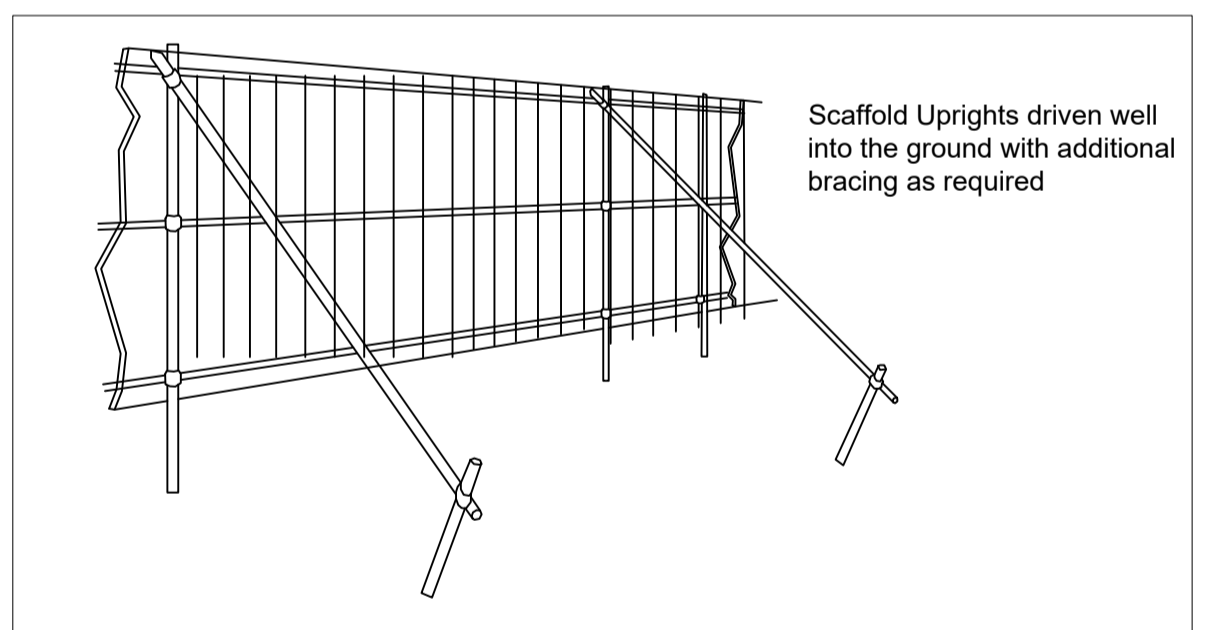

**TREE PROTECTION DETAIL:
HERRAS FENCING OR SIMILAR APPROVED**



REVISIONS			
REV	DATE	DESCRIPTION	
A	23,02,22	REVISED LAYOUT	
B	08,03,22	REVISED LAYOUT	

CMK CONSULTANTS & ARCHITECTS LTD		PROJECT:	DUNDUM VILLAGE STRATEGIC HOUSING DEVELOPMENT (PH1)	JOB NO:	TDUN009
CLIENT: Dundrum Retail GP DAC (acting for and on behalf of Dundrum Retail Limited Partnership)		DRAWING:	DVSHD - TREE PROTECTION 100% DRAWN BY: CAIRN KEATING CMK	DATE:	08-03-22
SCALE:		DRAWING NO:	1:250 @ A1	112	
STATUS:		REVISION:	CMK		

